



# 137 series

**2510 CONNECTOR 2.54mm(0.100" )**

Position	A	B	C	D
2	5.68	2.54	5.08	2.54
3	8.22	5.08	7.62	5.08
4	10.76	7.62	10.16	7.62
5	13.30	10.16	12.70	10.16
6	15.84	12.70	15.24	12.70
7	18.38	15.24	17.78	15.24
8	20.92	17.78	22.32	17.78
9	23.46	20.32	22.86	20.32
10	26.00	22.86	25.40	22.86
11	28.54	25.40	27.94	25.40
12	31.80	27.94	30.48	27.94
13	33.62	30.48	33.02	30.48
14	36.16	33.02	35.56	33.02
15	38.70	35.56	38.10	35.56
16	41.24	38.10	40.64	38.10

## Material & Finish

Insulator Material: Nylon 66 (UL 94V-0)

Contact Material: Brass

Contact Plated: Tin Plated

Number of Contacts: 2 Thru 16

Color: White

## How To Order

137 -09 S T  
 1 2 3 4  
 SERIES NO ———  
 NO.OF PINS: ———  
 2 TO 16  
 S-STRAIGHT TYPE ———  
 R-RIGHT ANGLE TYPE ———  
 H-HOUSING(WITH TERMINALS) ———  
 CONTACT PLATED:  
 T-TIN PLATED  
 G-GOLD PLATED

## [HOUSING]

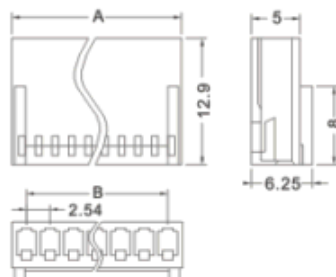

## [STRAIGHT]

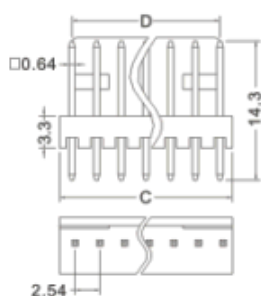

## [RIGHT ANGLE]

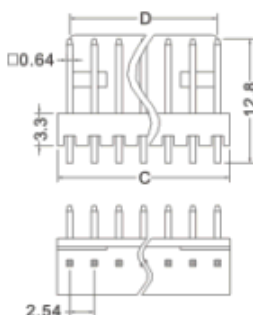

## [TERMINALS]

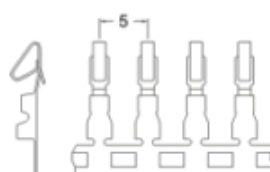

Kcr PXH2510-xx  
 Kcr PAW2600-xx  
 Kcr PAWR2600-xx

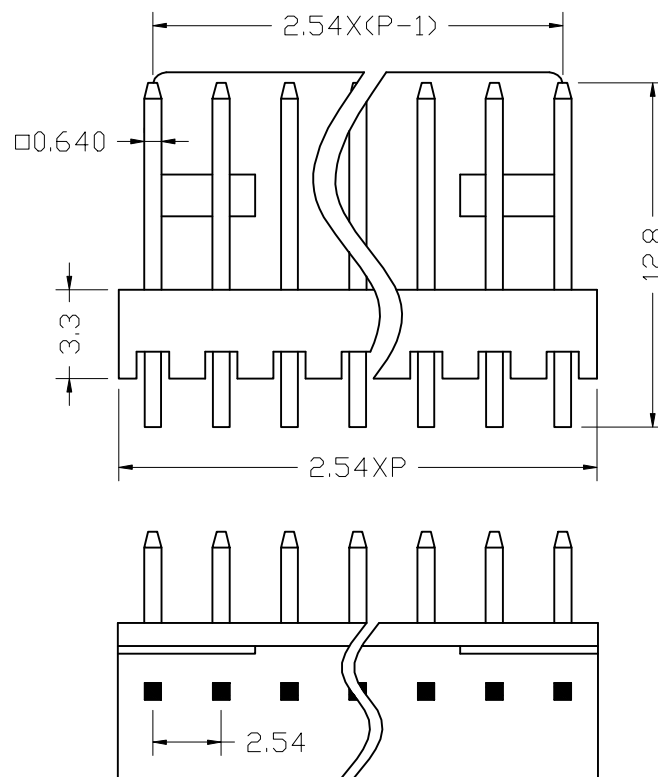
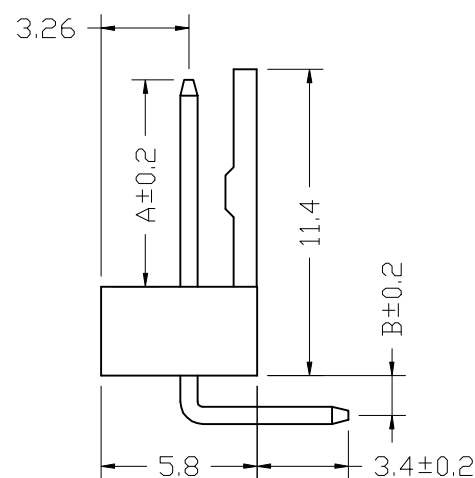

Kcr PXH2510-xx  
Kcr PAW2600-xx  
Kcr PAWR2600-xx

## MATERIAL & FINISH

**Insulator Material: Nylon 66(UL 94V-0)**

**Contact Material: Brass**

**Contact Plated: Tin plated**

**Number of contacts: 2 Thru 13**