

1 2 3 4 5 6 7 8

**** 抽第2PIN & 5PIN ****

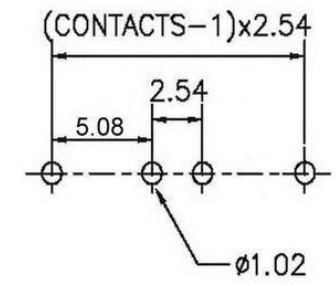
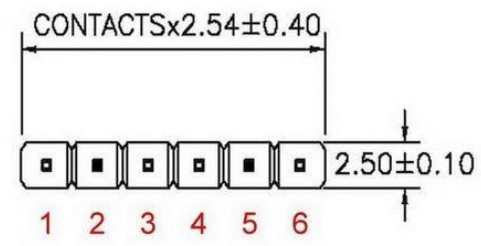

RECOMMENDED P.C.B LAYOUT

Kxl 2.54#06SG-2100S12

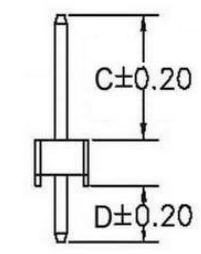
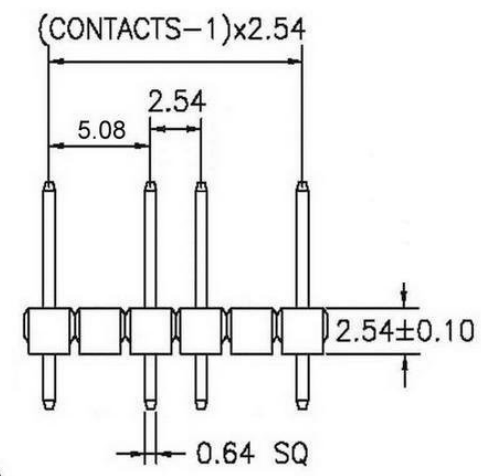

C= 7.1 mm D= 3.0 mm

MATERIAL
 HOUSING : THERMOPLASTIC PBT UL94V-0
 CONTACT : COPPER ALLOYS

SPECIFICATION
 CURRENT: 3A
 OPERATING TEMPERATURE: -55°C TO +105°C
 CONTACT RESISTANCE : 20 MILLIOHMS MAX
 INSULATION RESISTANCE : 1000 MEGAOHMS MIN
 WITHSTANDING VOLTAGE : AC 1000V RMS

RoHS Compliant				SEMIC TRADE, s.r.o. Volutová 2521/18 158 00 Praha 5 Czech Republic		www.semic.cz semic@semic.cz tel.: +420 251 625 331, 332, 377 fax: +420 251 626 252, 393	
APPD. 核准 HELEN	SCALE 比例 参考	TOLERANCE 容許公差 .0=±0.38 .00=±0.25 ANG=±5°	PART NAME 品名 2.54mm PIN HEADER SINGLE ROW 1X6P STRAIGHT TYPE FULL GOLD (C=7.1mm D=3mm) WITHOUT THE 2 & 5 PIN ROHS				
DWG. 製圖 ABBY	UNIT 單位 MM	SIZE. 紙張尺寸 A 4	PART NO. 料號 C2100-06ASGDH1R				
DATE 制表日 2013/10/18	PAGE 張數 1 OF 1	REV. 版次 A					

1 2 3 4 5 6 7 8

A
B
C
D
E
F
G
H

A
B
C
D
E
F
G
H