

Single turn Potentiometer

ET105 10mm Carbon Trimming Potentiometer

Carbon Resistive Element

Dust Proof Enclosure

Polyester Substrate

Wiper Position at 50% or fully clockwise

Supplied in magazines for automatic insertion

Long life model for low cost control potentiometer application

Self Extinguishable Plastic UL 94V0



Electrical Characteristics

Range of Value: 100Ω to 5MΩ

Resistance Tolerance: 100Ω to 1MΩ ±20%

Resistance Tolerance: 1MΩ to 5MΩ ±30%

Max. Voltage: 250VDC(lin), 125VDC(no lin)

Norminal Power@50°C: 0.25W(lin), 0.12W(no lin)

Residual Resistance: ≤0.5%Rn(2Ω min)

Equivalent Noise Resistance: ≤3%Rn(3Ω min)

Operating Temperature: -25°C to +70°C

Mechanical Characteristics

Mechanical Rotation angle: 265° ±5°

Electrical Rataion angle: 250° ±20°

Torqute: 0.5 to 2.5 N·cm

Stop Torque: ≥10N·cm

Soldering Conditions: 260°C, 5s max.

Marking: Resistance and date code

Standard Packing: 200pcs/bag

How To Order

Model **ET105 K - H - 103**

Rotors(K,M,W,X)

Mounting Method:
H=Horizontal
V=Vertical

Resistance Code

Standard Resistance Table:

Resistance (Ohms)	Resistance Code
220 - 5,000,000	221 - 505

ET105 Common Dimension & Adjust Method

Rotor type

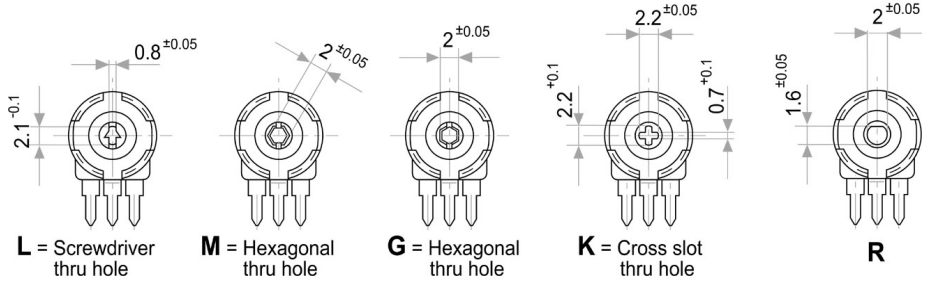

Adjust Side

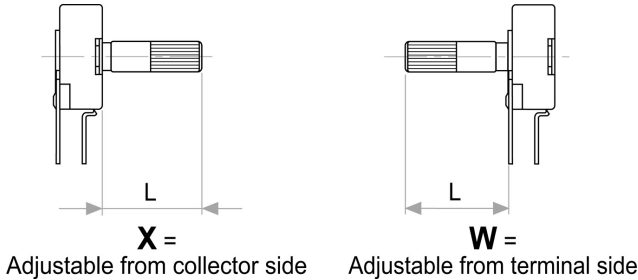

Adjust Type

v = horizontal mount – vertical adjust

h = vertical mount – horizontal adjust

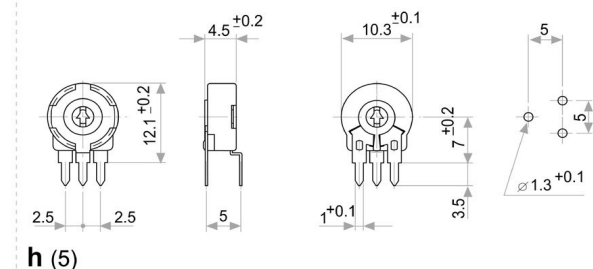
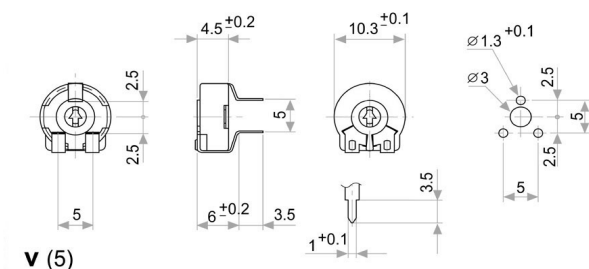
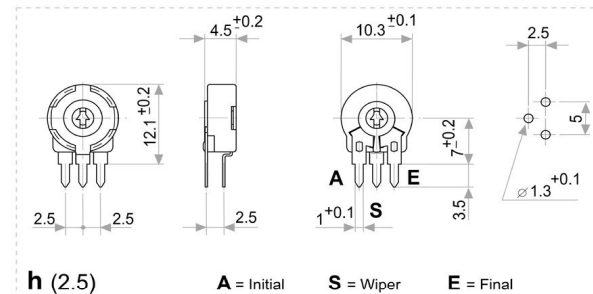
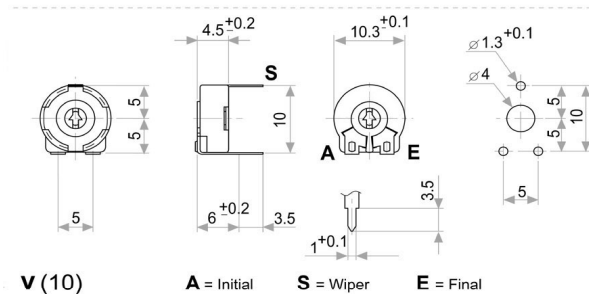

SEMIC TRADE, s.r.o.
Volutová 2521/18
158 00 Praha 5
Czech Republic

www.semic.cz
semic@semic.cz
tel.: +420 251 625 331, 332, 377
fax: +420 251 626 252, 393