

Rotary Code Switch

P36THR 1 21 L254 -

Angular 2.54 mm Through Hole Reflow

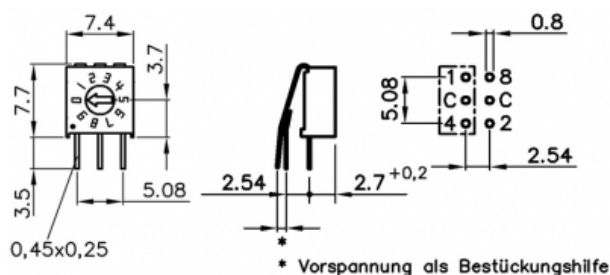
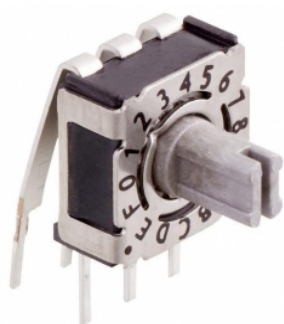

Mechanical Data

| | |
|------------------------------|---------------------------------|
| Type | vertical |
| Fixation mode | THR |
| Height | 7.7mm |
| Length | 5.24mm |
| Width | 7.4mm |
| Pin connection | 3+3 |
| Perm. ambient temperature | -50...+125°C |
| Perm. storage temperature | -55...+135°C |
| Torque | 1.2±0.2Ncm |
| Mech. lifetime | 25 000 steps |
| Positions per rotation | 10,16, more versions on request |
| Degree of protection | comparable IP67 |
| Sealing | O-Ring |
| Humidity | 21 days at 40°C, 93%RH |
| THR through holes | plated through |
| THR PCB hole diameter | 0.8mm |
| Outside diameter plated land | 1.8mm |
| Sinus-vibration testing | acc. IEC 68-2-6 |
| Frequency range | 10...500...10Hz, sliding |
| Acceleration | 10g |
| Amplitude | 6mm |
| Shock testing | acc. IEC 68-2-27 |
| Shock acceleration amplitude | 50g |
| Duration of nominal shock | 11ms |
| Directions | 6 (±x, ±y, ±z)3 times each |
| Reflow soldering | 10s/260°C |
| Wave soldering | 5s/280°C |
| Iron soldering | 4s/350°C |

- solid PCB pins
- contacts with abrasion resistant hard gold plating
- lateral C-contact
- extra sealed design with high temperature resistance
- switches are solder and flux sealed and washable
- 100% electronic inspection and testing
- 90° turned zero position available
- Pin rows with initial tension, no automated assembly possible



HARTMANN

Electrical Data

| | |
|-----------------------|-----------------|
| Operating voltage | $\leq 42V$ |
| Contact load, static | $\leq 0.4A$ |
| Contact load, dynamic | $\leq 0.1A$ |
| Minimum load | $1\mu A 20mVDC$ |
| Test voltage | 250V 50Hz/1min |
| Contact resistance | $< 80m\Omega$ |
| Insulation resistance | $> 100M\Omega$ |

Configuration

Actuators

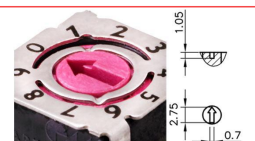

Arrow-shaped slot

Codes

| Dezimal Typ 21 | | | | | |
|-------------------|---|---|---|---|---|
| | C | 1 | 2 | 3 | 4 |
| 0 | ● | | | | ● |
| 1 | ● | ● | | | |
| 2 | ● | | ● | | |
| 3 | ● | | | ● | |

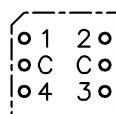

Decimal, 4

Contact pins

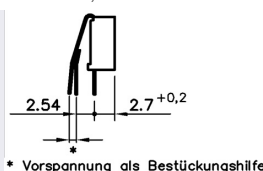

Left angular 2.54mm

Packing

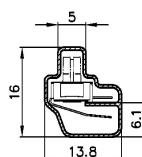

Tube