

## BN 3333

Cross recessed flat countersunk  
head screws  
Pozidriv Z

DIN 965 A  
~ISO 7046  
~UNI 7688

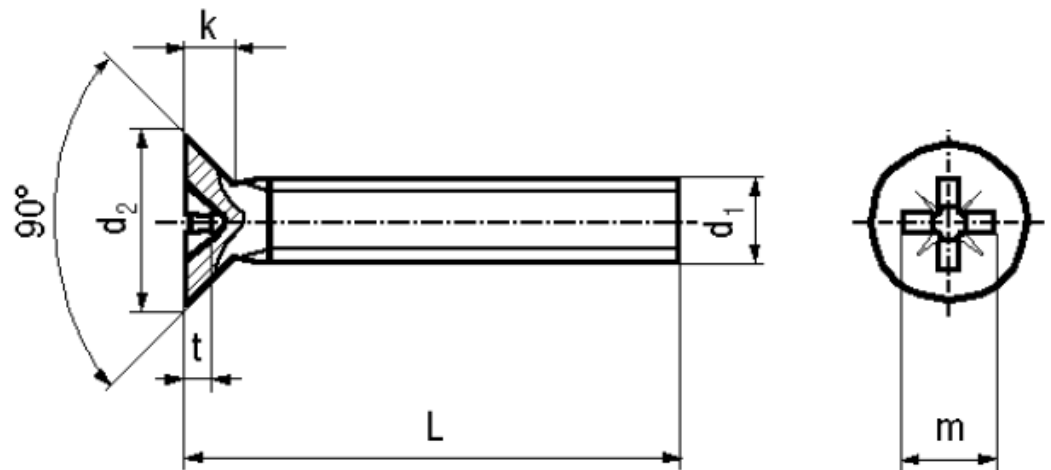

Material	<b>Steel</b>	Quality	<b>4.8</b>
Surface	<b>zinc plated blue</b>	Tensile strength	<b>400 N/mm<sup>2</sup></b>

Article No. - 2097052	
d <sub>1</sub>	M2,5
L	16
d <sub>2</sub> max.	4,7
k max.	1,5
Pozidriv	1
m~	2,5
t min.	1,22
t max.	1,47

DIN 965 A: Standard withdrawn  
DIN 965 A Phillips cross recess (Type H) see BN 388, BN 8167.  
All lengths fully threaded.